

QUANTUM EX200

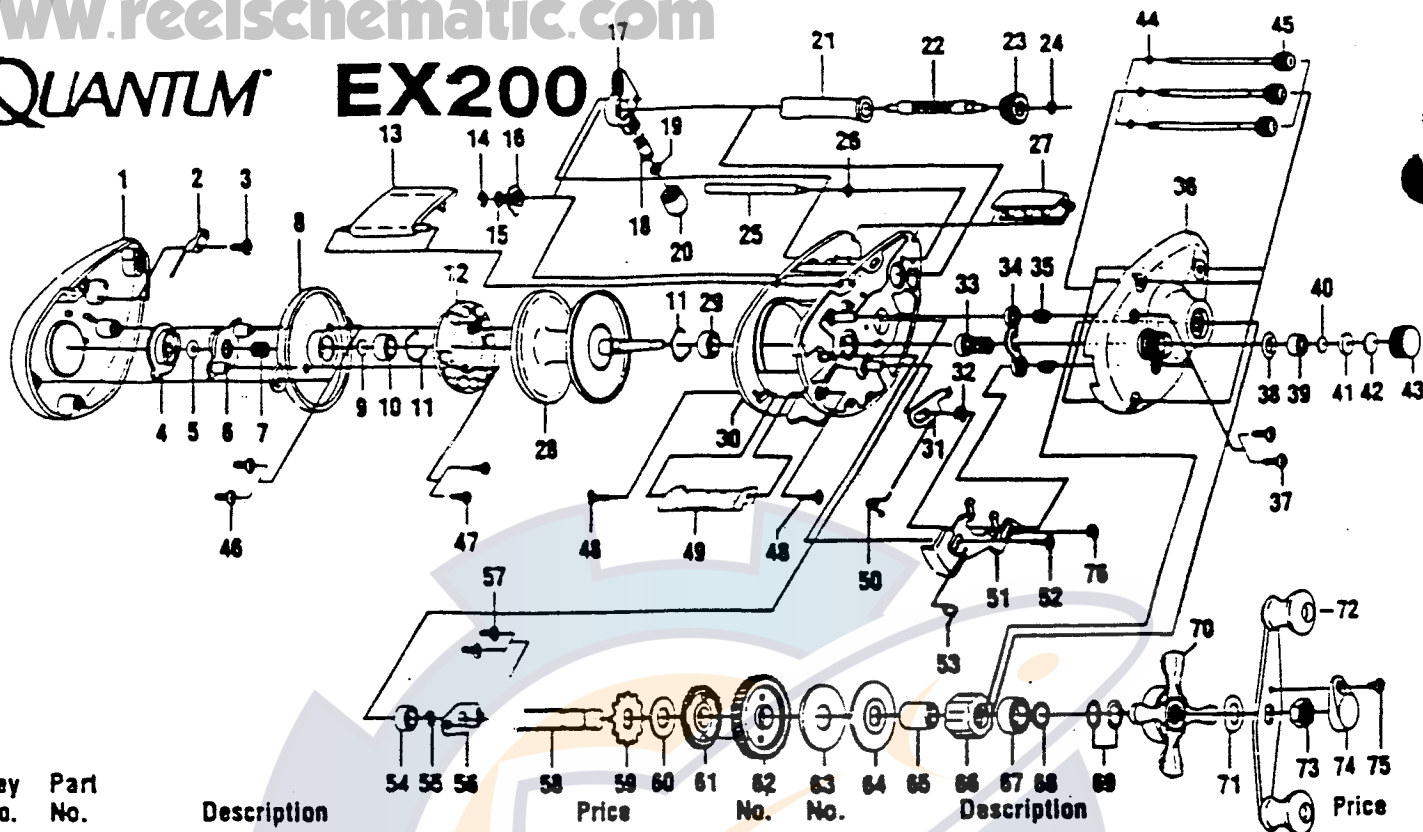

Key No.	Part No.	Description	Price	No.	Description	Price	
1	QW023	LEFT SIDE COVER	8.24	39	QW117	BEARING	8.45
2	QW108	CLICKER	.93	40	QW032-1	SPOOL TENSION KNOB	.52
3	QW125	SPOOL COVER SCREW	.93	41	QW081	COLLAR	.93
4	QW026	MAGNET CONTROL DIAL	1.24	42	QW082	SPOOL CUSHION WASHER	.93
5	CX4250	O RING	.49	43	QW033	SPOOL TENSION KNOB	2.83
6	QW028	SLIDE CAM	1.13	44	QW073	RING-THUMB SCREW RET.	1.13
7	CX4301	MAGNET RET. SPRING	.36	45	QW374	THUMB SCREW	1.13
8	QW051	SPOOL COVER	2.68	46	QW125	SPOOL COVER SCREW	.93
9	QW032-1	SPOOL TENSION KNOB	.52	47	QW076	SCREW	.62
10	QW017	CRANK SHAFT BEARING	6.59	48	QW050	THUMB REST SCREW	.93
11	QW080	CLIP RING	.52	49	QW009	THUMB REST	.93
12	QW330	MAGNET PLATE ASSY	5.51	50	QW097	KICK LEVER SPRING	.62
13	QW027	HOOD	5.46	51	QW339	RELEASE SLIDER ASSY	2.99
14	ZX4657	RETAINER CLIP	.69	52	QW057	RELEASE SLIDER SCREW	.62
15	QW035-3	WASHER - WORM SHAFT	.62	53	QW104	RELEASE SLIDER SPRING (COIL)	.93
16	QW067	WORM SHAFT BUSHING	.93	54	QW017	CRANK SHAFT BEARING	6.59
17	QW347	LINE GUIDE CARRIER	5.51	55	CX4152	WORM SHAFT RETAINER	.31
18	QW006	LINE GUIDE PAWL	2.68	56	QW002	CRANK SHAFT RETAINER	1.13
19	QW035-3	WASHER - WORM SHAFT	.62	57	QW107	CRANK SHAFT RET. SCREW	.93
20	QW007	LINE GUIDE CARRIER SCREW	2.16	58	QW008	CRANK SHAFT	5.41
21	QW016	WORM SHAFT GUIDE	1.91	59	QW083	TRIP RATCHET	1.70
22	QW072	WORM SHAFT	6.95	60	QW111	WASHER	.62
23	QW085	LEVEL WIND GEAR	1.70	61	QW112	GEAR - LW IDLER	1.49
24	VX4243	E-CLIP	.62	62	QW012	DRIVE GEAR	10.56
25	QW061	STABILIZER BAR	2.58	63	QW059	DRAG DISC	2.94
26	VX4243	E-CLIP	.62	64	QW045	DRAG WASHER	1.24
27	QW099	FRONT SUPPORT	3.24	65	QW052	CLUTCH SLEEVE	3.19
28	QW321	SPOOL ASSY	14.42	66	QW063	ANTI-REVERSE CLUTCH	10.56
29	SW017	CRANK SHAFT BEARING	6.59	67	TW058	BEARING - CRANK SHAFT TOP	6.70
30	QW001	FRAME	8.45	68	QW035	CRANK SHAFT WASHER	1.49
31	QW077	KICK LEVER	1.49	69	CX4662	DRIVE SHAFT SPR. W.SHR	.36
32	CX4152	WORM SHAFT RETAINER	.31	70	QW055	DRAG STAR	2.73
33	QW311	PINION GEAR	9.79	71	CX4660	HANDLE WASHER	.36
34	QW025	PINION YOKE	.93	72	QW318	HANDLE ASSY	6.18
35	QW040	PINION YOKE SPRING	.93	73	QW003	HANDLE NUT	1.60
36	QW324	RIGHT SIDE COVER	8.55	74	QW034	HANDLE NUT CAP	.93
37	QW053-2	RIGHT SIDE COVER SCREW	.93	75	QW123	HANDLE NUT CAP SCREW	.93
38	CX4258	O RING	.36				

Prices subject to change without notice. Prices do not include postage and handling.

PLEASE ORDER BY PART NUMBER

Rev. 5/93 Zebco Division Brunswick Corporation, Box 270, Tulsa, OK 74101 USA 918-836-5581

